

24m Survey & Research Vessel, UK MCA Category 2, Fully COWRIE Compliant



Coastline Surveys Ltd is justifiably extremely proud of the capabilities of our multi-purpose 24m survey & research vessel MV FlatHolm. She has proven to be an ideal platform as a multi-purpose survey ship and coastal support vessel suitable for many differing UK & near-European projects. She also has worked for most of the major European survey contractors as a 3rd party charter vessel.

Specialist areas of operation include site, pipeline & cable route surveys using geotechnical (CPT, grab and vibrocore sampling), geophysical (shallow seismic and

sonar surveys) and bathymetric surveys (swath multibeam and single beam surveys). She has also been used by a variety of agencies for deployment and recovery of extra heavy duty metocean equipment, trawling and benthic studies and ornithological studies.

MV FlatHolm is fully COWRIE compliant and importantly is one of very few UK vessels available in her class that complies fully with these specifications. Continual planned upgrades of machinery, communications and accommodations reflect our increasing commitment to offer MV FlatHolm as a class beating coastal survey ship.

COASTLINE SURVEYS LIMITED

MV FlatHolm



Principal Features Classification:

UK MCA MECAL CoP 2: 60nm
Certificate No: M02WB022107
Port of Registry: Cardiff
Length Overall: 23.3 metres
Breadth Overall: 8 metres
Breadth Moulded: 7.2 metres
Deck Area: 50m² deck area
Draft: 2.5 metres (2.8 metres loaded)
Speed Min/Max: 3 knots / 9 knots
Power: 2 x 350hp continuous rated
Bollard Pull: 10 tonnes
Range: 4500nm

Suitable Uses

Geotechnical surveys (CPT, vibrocore, grab),
geophysical surveys (pinger, boomer), sidescan sonar
multibeam (swath) surveys, metocean equipment
deployment, environmental surveys (trawling, benthic),
ROV inspection, towed body deployment,
hydrographic survey support.

Accommodation Areas

6 cabins for 12 persons in total. Mess area with TV
Video. Galley with permanent cook.

Machinery & Control

Main Engines: 2 x Cummins NTA855M 350hp
continuous rated to Twin Disc gearboxes. Two control
stations plus engine room.

Main Propulsion

2 x 1800mm Kaplan Propellers in fixed Kort Nozzles

Generators

2 x 85 kVA 3 ph 415V ac

Power Supplies

1 x 65kVA 63A 415v 50Hz AC supply for deck
1 x 220v 32A 50Hz AC supply for deck
1 x 220v 16A 50Hz AC supply for lab
1 x 24v DC supply for bridge / lab electronics
1 x 12v DC supply for bridge / lab electronics

Stern / over the side

Working CCTV, intercom and headsets for bridge
communication.

Safety System

CCTV, MOB alert, 5.4m AVON RIB quick launch
rescue / work boat.
Comprehensive QA system with Standard
Safety/IMCA audits completed.

Consumption

Transit= 100l / hour
On survey= 100l / hour
Standby at sea= 50l / hour
Standby alongside= 50l / hour

Handling Facilities

Hydraulic Deck Crane HyTek Sea Crane 14 t/m with
high speed 1.5t sampling winch

Duration: Up to 10 days
Gross tonnage: 128 GRT
Net tonnage: 39 NRT
Displacement: 220 tonnes
Fuel Capacity: 44m³
Freshwater: 9m³
Blackwater: 2m³
LSA / Accommodation: 12 persons plus 4 crew
Callsign: G H L Z
Official Number: 712571
Year Built: 1977
Location: Japan

Tugger Winch SAMIA Hydrobloc S35 3.5t SWL
A-Frame Aft 6.5t SWL
Deck Winch Gearmatic 6.5t SWL
4 point mooring system available

Navigational Equipment

2 x Raymarine radar including MARPA
1 x Sperry Robertson Autopilot
2 x Furuno colour echosounders
2 x CSI dGPS compass systems
UKHO Admiralty Electronic charting
Starfix Satellite differential GPS

External Communications

2 x Sailor VHF DSC GMDSS
2 x handheld VHF for deck operations
GSM mobile & GSM fax
Satcomms via Iridium

Pumps

Pumps 2 x 2", 2 x 1.5" Fire/bilge deck wash

Special Features

COWRIE Compliant for Ornithological Surveys:
Exceeds the minimum eye height: (5.8m and
8.1m seated)
Exceeds the minimum cruising speed: (8.5 knots)
Exceeds the minimum vessel size: (23.5m)
Complies with not being a past or present fishing
vessel
Provides ample space for multiple observers on
both sides
Provides comfortable accommodation for off
watch periods
Survey sensor instrumentation available
Upgraded to Residential Quality Exhaust Silencing

Survey Equipment Available

Vibrocoring (3-6m) & CPT (20kN) equipment
Multibeam (swath) bathymetry systems
Multi-axis heave compensator systems
Geophysical profiling pinger and boomer
systems
ROV for biological, geological survey and
inspection
Dual frequency sidescan sonar systems
Seabed grab samplers (Hamon, Day, Van Veen
etc) 2m and 4m beam trawls
Box corer, gravity piston and drop corer

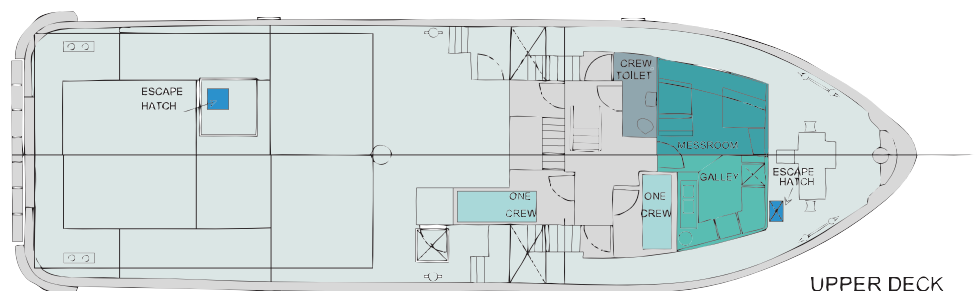
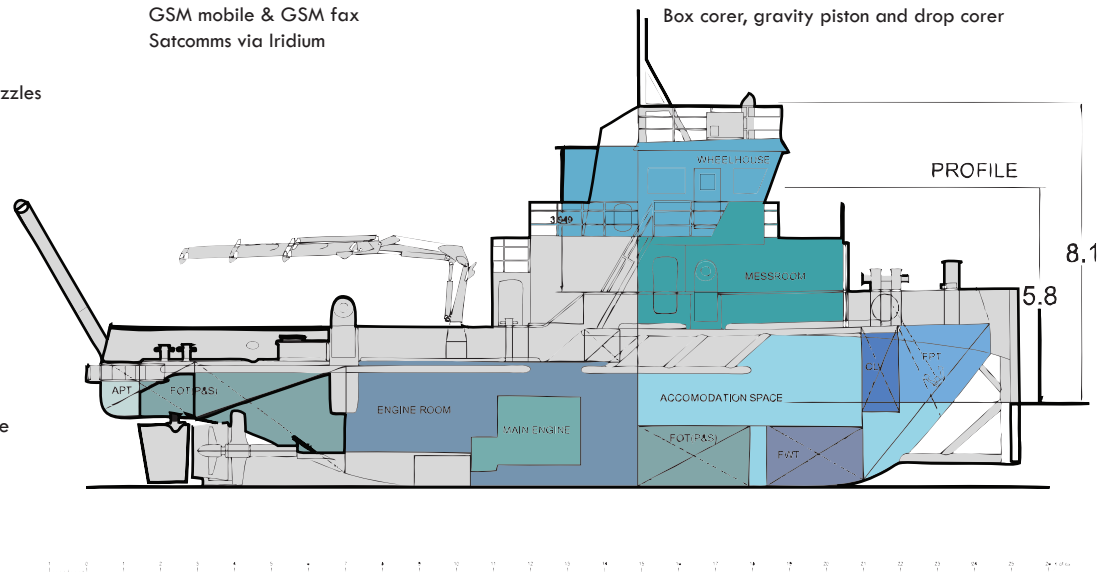

Photo: www.fotoflite.com